



The heart piece of your treatment
Our Forestadent BioArchwires



www.forestadent.com

 **FORESTADENT®**
GERMAN PRECISION IN ORTHODONTICS

The intelligent archwire for every treatment stage



BioStarter®: Round archwires for a perfect start to your orthodontic treatment

BioTorque®: Square and Rectangular archwires for efficiency when you need to express detail

BioFinisher®: Square archwire for perfect completion of treatment

BioLingual®: Round archwire for intelligent lingual treatment

BioCosmetic®: Durable, perfect aesthetics

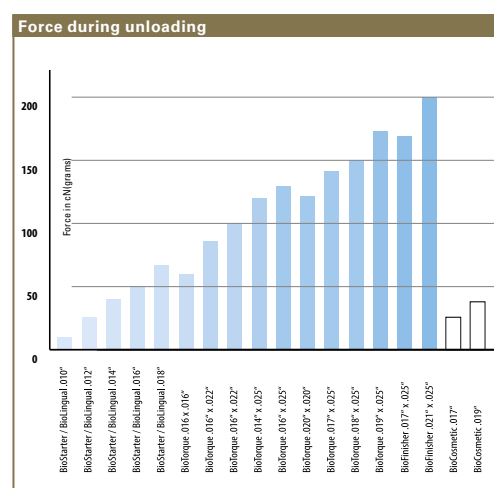

The correct force for each treatment phase.

In orthodontics, just like in car racing, the correct application of force and torque is crucial: too much of either and you will get unwanted side effects, too little and nothing happens at all. Archwires are the engine of orthodontic tooth movement. During each treatment phase the correct choice of archwire should guarantee the correct force application. You will reach your treatment goals faster without unwanted side effects. When using BioArchwires from FORESTADENT you can choose the correct force levels for any stage of your treatment.

Faster treatment progress due to efficient force application.

The uniquely smooth surface of BioArchwires reduces the friction between archwire and bracket by up to 30 %. Due to the combination of the unique characteristics these intelligent wires from FORESTADENT® work more gently and efficiently. The orthodontic treatment will be completed faster. When using BioArchwires treatment can be completed with fewer archwires in a shorter period of time – a more economical solution for the clinician and the patient.

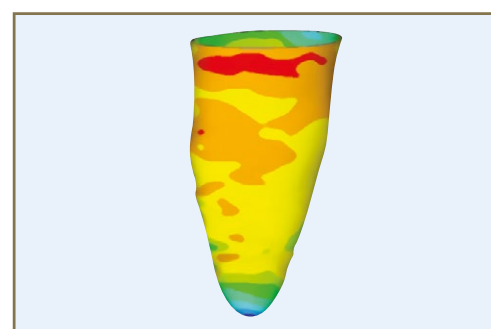

Pressure on the root of a premolar undergoing intrusion during orthodontic treatment.

*[Wurzelresorptionen an oberen ersten Prämolaren...Rolf Faltin et al., Fortschritte der Kieferorthopädie 1998, 59:208-219 (Nr. 4)]

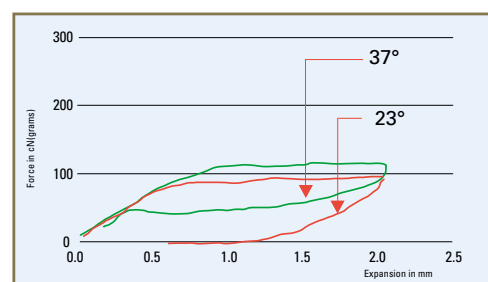

Constant force development at body temperature.

Clinically proven

A clinical study* confirms that the low forces expressed by BioStarter® round arch wires can help to avoid resorption when the correct archwires and archwire sequence is applied. The results of the clinical study have been verified by using the Finite Element Method (please see picture).

Shape Memory – gentle treatment thanks to special alloy (NiTi).

Force changes due to temperature variations are greatly reduced in the BioArchwires due to the use of a special alloy. All temperature changes are reversible. Due to this characteristic the influence of cold and hot foods and drinks results in intermittent levelling. When the forces applied by the archwire become uncomfortable for the patient a glass of cold water can almost instantly take away the discomfort.

Friction values (square wire)

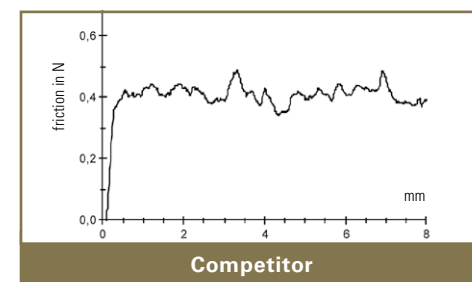
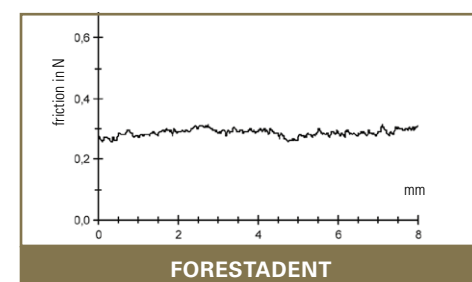

The smooth surface of FORESTADENT BioArchwires reduces the friction between archwire and bracket by up to 30%.

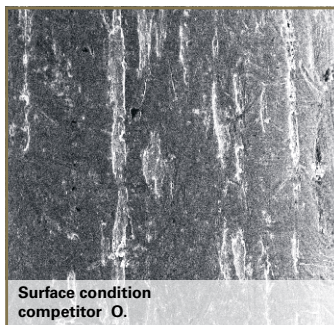
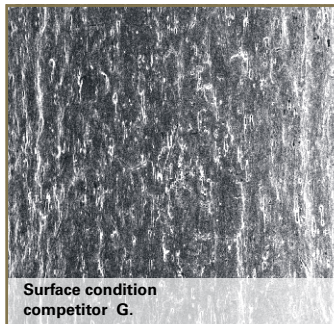
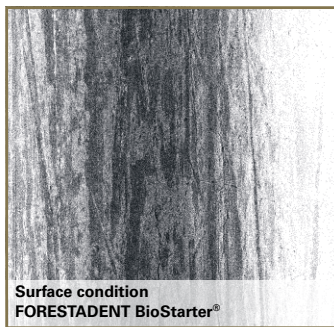

The uniquely smooth surface of BioStarter® and BioTorque® archwires reduces friction and allows faster and more efficient treatment progress.

BioStarter® round 0.010" – for particularly sensitive patients

The smallest BioStarter® archwire with the dimension 0.010" broadens the application of BioStarter® archwires even further. This archwire will work in the most adverse conditions, e.g. periodontally compromised patient and malocclusion can be corrected with the lightest of forces totally risk free and extremely gentle. Until now stranded wires with high friction and poor elasticity had to be used for these applications leading to extended treatment times. The BioStarter® archwire is also suitable on sensitive and anxious patients.

BioTorque® square and rectangular wires – efficiency for all dimensions

Torquing generates a high degree of bone absorption and reformation. During this process high forces are expressed on teeth which can have a damaging effect on the dentition. The new thermoactive BioTorque® archwires from FORESTADENT are extremely gentle and can help to reduce long term damage. Due to the extremely precise dimensions of the FORESTADENT wires exact torquing is a lot easier. BioTorque® archwires feature the same unique surface finish as the BioStarter® archwires helping to keep friction to a minimum. Together with the extreme superelasticity BioTorque® archwires work very efficiently and super fast. BioTorque® archwires can be used in extremely difficult cases without any risk, e.g. sensitive or compromised patients.

BioFinisher® square archwire – for perfect completion of treatment

In some cases at the end of bracket treatment there is poor intercuspitation in the posterior region (caused by too little or incorrect torque) and straightening in the anterior region (caused by frequent tightening of elastic chains during diastema closure). The retruded teeth can be realigned by using the BioFinisher® at the end of treatment. The BioFinisher® is a thermosensitive archwire that virtually fills the slot. It also has a very smooth surface due to its special plasma conditioning. As the final archwire, the dimensions of the BioFinisher® ensure transfer of virtually all the preset values in each bracket.

BioLingual® round archwire for intelligent lingual treatment

Thermoactive bioarchwires are not only available for the vestibular treatment of teeth but also for lingual treatment. The BioLingual® archwires are mushroom shaped and can be ordered in six different forms with four dimensions each (.010", .012", .014", und .016"). Over 200 jaws were digitally recorded for determining the optimal shapes, which provided the basis for calculating the respective arch shapes. The nickel-titanium BioLingual® archwires generate their optimal force at body temperature, in the same way as the popular BioStarter® and BioTorque® archwires.

What are you waiting for?

It's time for a change. Order your BioStarter®, BioTorque®, BioLingual® and BioFinisher® wires today and change to the intelligent and patientfriendly technology from FORESTADENT. FORESTADENT technology - for your and your patients benefit.

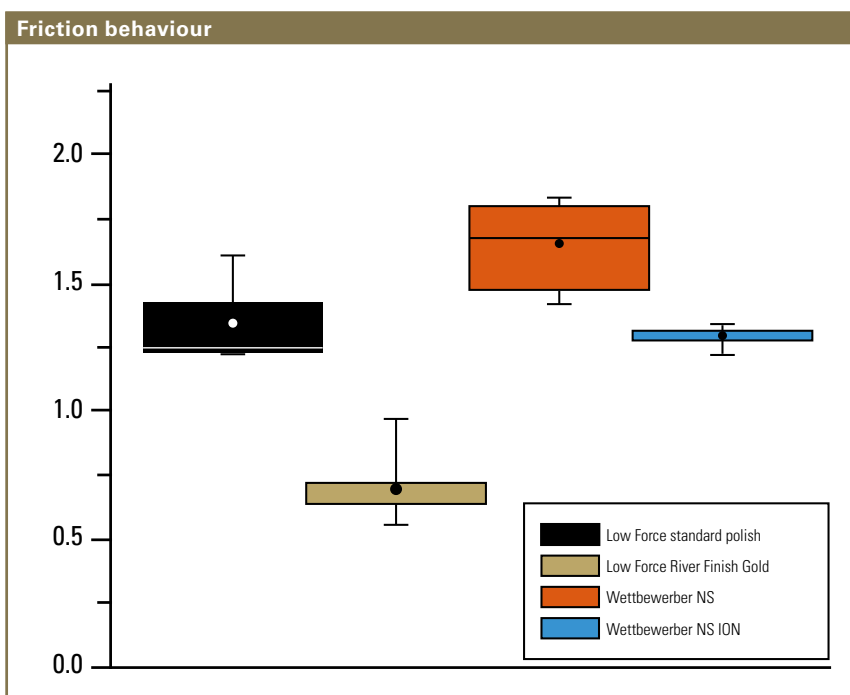

The effect of different surface coatings (River Finish Gold and ion implantation) on the friction behaviour in comparison with uncoated archwires.



River Finish Gold

Over 111 years of working with surface polishing is ideal for creating the optimum arch wires. Inspired by the smooth surface of river stones, FORESTADENT archwires undergo a unique treatment process Called River Finish Gold. The result is ultra-smooth archwires with low friction. The best possible foundation for a perfect treatment result.

CE 0297

BioStarter®, BioTorque®

Individually packed



Straight-Arch-Form



Euro-Smile-Form



description	Order No. Maxillary	Order No. Mandibular	Order No. Maxillary	Order No. Mandibular	profile	force	ø inch	contents
BioStarter®	203-0825	203-0925	203-1825	203-1925		20 g	.010"	10
	203-0830	203-0930	203-1830	203-1930		30 g	.012"	10
	203-0835	203-0935	203-1835	203-1935		40 g	.014"	10
	203-0840	203-0940	203-1840	203-1940		50 g	.016"	10
	203-0845	203-0945	203-1845	203-1945		70 g	.018"	10

BioTorque®	203-2035	203-2135	203-4035	203-4135		120 g	.014" x .025"	10
	203-1440	203-1540	203-3440	203-3540		60 g	.016" x .016"	10
	203-2040	203-2140	203-4040	203-4140		100 g	.016" x .022"	10
	203-2440	203-2540	203-4440	203-4540		135 g	.016" x .025"	10
	203-2044	203-2144	203-4044	203-4144		140 g	.017" x .025"	10
	203-1445	203-1545	203-3445	203-3545		90 g	.018" x .018"	10
	203-2046	203-2146	203-4046	203-4146		150 g	.018" x .025"	10
	203-2048	203-2148	203-4048	203-4148		170 g	.019" x .025"	10
	203-1450	203-1550	203-3450	203-3550		130 g	.020" x .020"	10

BioFinisher®

Individually packed



Straight-Arch-Form









Euro-Smile-Form



description	Order No. Maxillary	Order No. Mandibular	Order No. Maxillary	Order No. Mandibular	profile	force	ø inch	contents
	203-2054	203-2154	203-4054	203-4154		140 g	.017" x .025"	10
	203-2053	203-2153	203-4053	203-4153		200 g	.021" x .025"	10



BioLingual® archwires

size	profile	force	content	 shape 1	 shape 2	 shape 3	 shape 4	 shape 5	 shape 6
.010"	●	20 g	10	270-0125	270-0225	270-0325	270-0425	270-0525	270-0625
.012"	●	30 g	10	270-0130	270-0230	270-0330	270-0430	270-0530	270-0630
.014"	●	40 g	10	270-0135	270-0235	270-0335	270-0435	270-0535	270-0635
.016"	●	50 g	10	270-0140	270-0240	270-0340	270-0440	270-0540	270-0640

BioLingual® archwires – customised packed

size	profile	force	Order No.	content			
				shape 2	shape 3	shape 4	shape 5
.012"	●	30 g	270-0030	2	3	3	2
.014"	●	40 g	270-0035	2	3	3	2
.016"	●	50 g	270-0040	2	3	3	2





BioCosmetic®-archwires – durable, perfect aesthetics.

BioCosmetic®-archwires are the first tooth-coloured archwires that remain constantly white and therefore enable long-term aesthetical treatment. They also provide maximum intraoral comfort for the patient, as the white coating covers superelastic NiTi archwires. These Archwires ensure gentle forces and quick treatment due to their extremely low force level.

The time required for changing a BioCosmetic®-archwire is the same as that for uncoated archwires. Even the use of self-ligating brackets, which generally allow longer intervals for archwire changes, does not present a problem for BioCosmetic®-archwires. Their tooth-coloured coating remains intact ensuring perfectly maintained aesthetics. Regardless of whether the bracket slots are made of metal or ceramic, BioCosmetic®-archwires maintain their white coating without any problem for six to eight weeks.

In addition we recommend to use patient friendly brackets with rounded bracket and slot edges as for example the QuickKlear® bracket by FORESTADENT. BioCosmetic®-archwires, however, should not be adapted or bent, as sharp objects may damage the white coating.

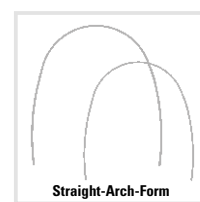
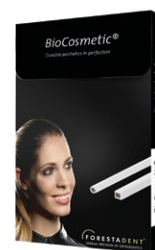

CE 0297

description	Order No. maxillary	Order No. mandibular	profile	force	ø inch	ø mm	contents
BioCosmetic Superelastic	217-0845	217-0945	●	25 g	.017"	0,43	10
	217-0850	217-0950	●	35 g	.019"	0,48	10
	217-1440	217-1540	■	55 g	.016" x .016"	0,40 x 0,40	10
	217-2040	217-2140	■	90 g	.016" x .022"	0,41 x 0,56	10
	217-2046	217-2146	■	135 g	.018" x .025"	0,46 x 0,64	10

FORESTADENT Bernhard Förster GmbH
Westliche Karl-Friedrich-Str. 151 • 75172 Pforzheim (Germany)
Phone: +49 (0) 7231 459-0 • Fax: +49 (0) 7231 459-102 • info@forestadent.com

www.forestadent.com

FORESTADENT®
GERMAN PRECISION IN ORTHODONTICS