

Advantages at a glance.

- **Optimal aesthetics** thanks to permanent translucent ceramics and free of discolouration
- **Shorter treatment time and quicker success** due to less friction of the archwire
- **Fewer follow-up appointments** as the ligatures do not need replacing
- **Shorter treatment periods** due to simpler and quicker replacement of archwires
- **Comfortable to wear** – no sharp corners and edges
- **Reduced feeling of tightness** as lower forces are possible with the archwires
- **Easier to care for** as there are no interfering ligatures to harbour debris



Reliability & precision made in Germany.

FORESTADENT is specialised in manufacturing orthodontic materials and is among the world leaders in this segment. The company was founded in 1907 as a manufacturer of jewellery and produced watches until well into the 1970's with their own movement. Even today, FORESTADENT benefits from its know-how in manufacturing minute high-precision parts in combination with advanced surface finishing.

The company has been family-run for four generations. For over 100 years, FORESTADENT has been manufacturing in its main facility in Pforzheim and markets its products in over 80 countries.

Extensive information on the topic of orthodontic treatment is available on the Internet at www.mysmilemybraces.com.



Contact your clinician to discuss the best options for you.

FORESTADENT[®]
GERMAN PRECISION IN ORTHODONTICS



Quicklear[®] Brackets

Inconspicuous and quick approach to a perfect smile.



FORESTADENT[®]
GERMAN PRECISION IN ORTHODONTICS

Inconspicuous and quick approach to a perfect smile.

Wearing braces is absolutely normal these days for young persons. These days, more and more adults decide to have orthodontic treatment. No matter which age group the patients belong, they all have the same ambitions: the braces should be as inconspicuous as possible and treatment should be completed as quickly as possible. Quicklear, the state-of-the-art, self-ligating ceramic brackets by FORESTADENT, satisfy both these wishes.

What does “self-ligating” mean?

In principle, fixed braces consist of so-called brackets which are bonded to the teeth, and an archwire which moves the teeth into the desired position by applying elastic pressure. In normal standard brackets the archwire is fixed with rubber rings or thin metal wires - so-called ligatures. Ligatures act like knots and the bracket can no longer slide along the archwire easily. This has a negative effect on the transfer of forces. Quicklear Brackets do not require ligatures. A small integrated metal clip is slid over the inserted archwire and embraces it without clamping it tightly. Quicklear Brackets virtually ligate themselves.

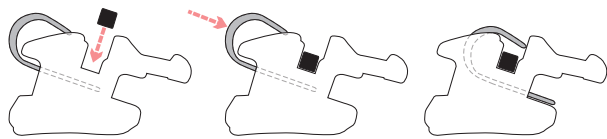

Ligating of an archwire into Quicklear Brackets.

Why Quicklear makes your treatment quicker and more pleasant.

Quicklear Brackets can slide along the archwire easier due to lower friction. This leads to quicker treatment results than with standard brackets. Less force is required to move teeth with Quicklear Brackets. This makes for a more pleasant treatment experience. For added comfort: all corners and edges are rounded optimally. The Quicklear clip can be opened and closed quickly. This way you spend less time chairside. The metal clip also has a longer service life than normal ligatures which need to be replaced on a regular basis. The number of appointments with the orthodontist is reduced accordingly.

Aesthetics and hygiene.

Quicklear Brackets are made of a special translucent ceramic. This allows the natural colour of your teeth to shine through. Quicklear Brackets adapt to the colour of the teeth and are therefore virtually invisible. Classical ligatures are not required due to the separately mounted clip. This makes cleaning easier for you and improves oral hygiene. Neither the ceramic bracket nor the metal clips are discoloured by food and drinks. As a result, Quicklear remains extremely inconspicuous throughout the entire treatment period.

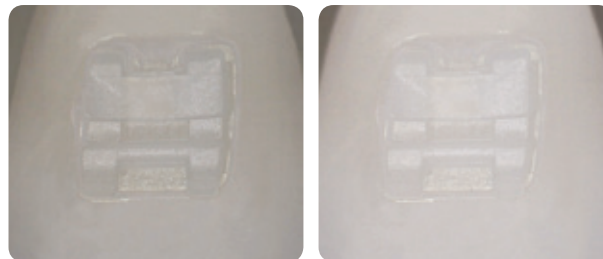

The translucent ceramic Quicklear Brackets adapt to the colour of the teeth and are therefore virtually invisible.



Perfect combination.

Fixed braces do not only consist of brackets. The actual forces which move the teeth are created by an elastic archwire inserted into the brackets. When deciding in favour of treatment with high-quality, state-of-the-art brackets, one should also consider archwires of corresponding quality. The FORESTADENT BioArchwires are made of ultra-elastic material resulting in especially fast and caring treatment. This allows full exploitation of the benefits of self-ligating brackets. Further information on the FORESTADENT archwires is given in our separate “BioArchwires” brochure.